

PENNSYLVANIA JUDO, INC.

REFEREE SEMINAR

Saturday, November 19, 2005
Registration 9:00 AM – 9:30 AM
Clinic 10:00 AM – 3:00 PM

University of Pittsburgh
Trees Hall – Allequippa & Darragh Sts
Multipurpose Room

Clinicians

Jae Kim

Joon Chi

IJF-A (International) Referees

Free to Pennsylvania Judo, Inc., members
\$40 for non-USJI and non-Pennsylvania USJI participants

For more information contact:

Mr Kyu-Ha Kim *or* Ms Dee Nicholas
Kim's Martial Arts & Fitness
412-881-5066

PENNSYLVANIA JUDO, INC.
REFEREE SEMINAR
REGISTRATION FORM

Name _____

Address _____

Telephone _____

Email _____

Club _____

Rank _____

Referee Level _____

USJI# _____

PA Judo _____ Non-PA Judo _____
(Free) (\$40)

*Anyone who has registered with USJI using a Pennsylvania mailing address
is automatically a member of Pennsylvania Judo. Proof of USJI membership required!*

Include check, this form, the signed waiver and a copy of
your USJI membership card by November 12:

Mail to Kim's Martial Arts & Fitness
3606 Brownsville Rd
Pittsburgh, PA 15227-3118

Payable to Kim's Martial Arts & Fitness

WARNING!

WAIVER AND RELEASE OF LIABILITY AND AGREEMENT TO PARTICIPATE

In consideration of being permitted to participate in any way, including travel to and from, in any Judo tournament, practice, clinic, and related events and activities of United States Judo, Inc., United States Judo Federation, United States Judo Association, Pennsylvania Judo, Inc., Kim's Martial Arts, Inc. and/or University of Pittsburgh, I hereby:

1. Acknowledge that I am familiar with the sport of Judo and understand the rules governing the sport of Judo.
2. Agree that prior to participating, I will inspect the mats, equipment, facilities, competition pools or divisions and the elimination or scoring system to be used, and if I believe anything is unsafe or beyond my capability, I will immediately advise my coach, supervisor, the clinician, and/or a tournament official of such conditions and refuse to participate.
3. Acknowledge and fully understand that I will be engaging in a contact sport that might result in serious injury, including permanent disability or death, and severe social and economic losses due to not only my own actions, inactions, or negligence, but also to the actions, inactions, or negligence of others, the rules of the sport of Judo or conditions of the premises or of any equipment used. Further, I acknowledge that there may be other risks not known to me or not reasonably foreseeable at this time.
4. Knowing the risks involved in the sport of Judo, I assume as such risk and accept personal responsibility for the damages following such injury, permanent disability, or death.
5. Release, waive, discharge and covenant not to sue the United States Judo, Inc., United States Judo Federation, United States Judo Association, Pennsylvania Judo, Inc., Kim's Martial Arts, Inc., University of Pittsburgh, together with their affiliated clubs, their respective administrators, directors, agents, coaches and other employees or volunteers of the organization, event officials, medical personnel, other participants, their parents, guardians, supervisors and coaches, sponsoring agencies, sponsors, advertisers, and if applicable, owners, lessors and lessees of premises used to conduct the event, all of whom are hereinafter referred to as: "releasee", from any and all claims, demands, losses, or damages on account of injury, including permanent disability and death and damage to property, caused or alleged to be caused in whole or in part by the negligence of the releasee or otherwise to the fullest extent permitted by law.

I HAVE READ THE ABOVE WARNING, WAIVER AND RELEASE, UNDERSTAND AND THAT I GIVE UP SUBSTANTIAL RIGHTS BY SIGNING IT, AND KNOWING THIS, SIGN IT VOLUNTARILY. I AGREE TO PARTICIPATE KNOWING THE RISK AND CONDITIONS INVOLVED AND DO SO ENTIRELY OF MY OWN FREE WILL. I AFFIRM THAT I AM AT LEAST 18 YEARS OF AGE, OR, IF I AM UNDER 18 YEARS OF AGE, I HAVE OBTAINED THE REQUIRED CONSENT OF MY PARENT/GUARDIAN AS EVIDENCED BY THEIR SIGNATURE BELOW.

Participant (please print name)

Participant Signature

Date

FOR PARENTS/GUARDIANS OF PARTICIPANTS OF MINORITY AGE (UNDER AGE 18 AT TIME OF REGISTRATION)

This is to certify that I, as parent/guardian with legal responsibility for this participant, do consent and agree to his/her release, as provided above, of all the Releasees, and for myself, my heirs, assigns, and next of kin, I release and agree to indemnify and hold harmless the Releasees from any and all liabilities incident to my minor child's involvement or participation in these programs as provided above, even if arising from their negligence, to the fullest permitted by law. I have instructed the minor participant as to the above warnings and conditions and their ramifications.

Parent/Guardian (please print name)

Parent/Guardian Signature

Date

2005 Pennsylvania Referee Seminar

DIRECTIONS TO UNIVERSITY OF PITTSBURGH TREES HALL

From the North:

- Take 179 South to Exit 72/1279 South (exit on left)
- Take 1279 South to Exit 8A/1579 South
- Take the exit for 1376 East (Oakland/Monroeville – exit on left)
- Stay straight to go onto the Blvd of the Allies
- Take the Forbes Ave Exit
- Turn Left onto McKee Place
- Follow directions at the bottom (see map)

From the South:

- Take 179 North to Exit 59A/1279 North
- Take Exit 6A/1376 East/Monroeville
- Take Exit 2A/Forbes Ave/Oakland
- Turn Left onto McKee Place
- Follow directions at the bottom (see map)

From the Northwest:

- Take 180 East to Exit 19A/179 South and follow the directions from the North.

From the Southwest:

- Take 170 East to Exit 18/179 North and follow the directions from the South.

From the East:

- Take 176 West to Exit 57/1376 West toward Pittsburgh
- Take the Exit 3B/Oakland and bear right onto Bates Street
- Stay straight through the traffic light
- Take the second left onto McKee Place
- Cross Forbes Ave at the traffic light
- Follow directions at the bottom (see map)

From McKee Place:

- Cross Fifth Ave at the traffic light and McKee Place becomes Darragh Street
- At the very top of the hill (and a traffic light) you will be facing Trees Hall
- To park, turn right onto Allequippa Street and then turn left into the University of Pittsburgh OC Lot (Cost: \$5-\$7)

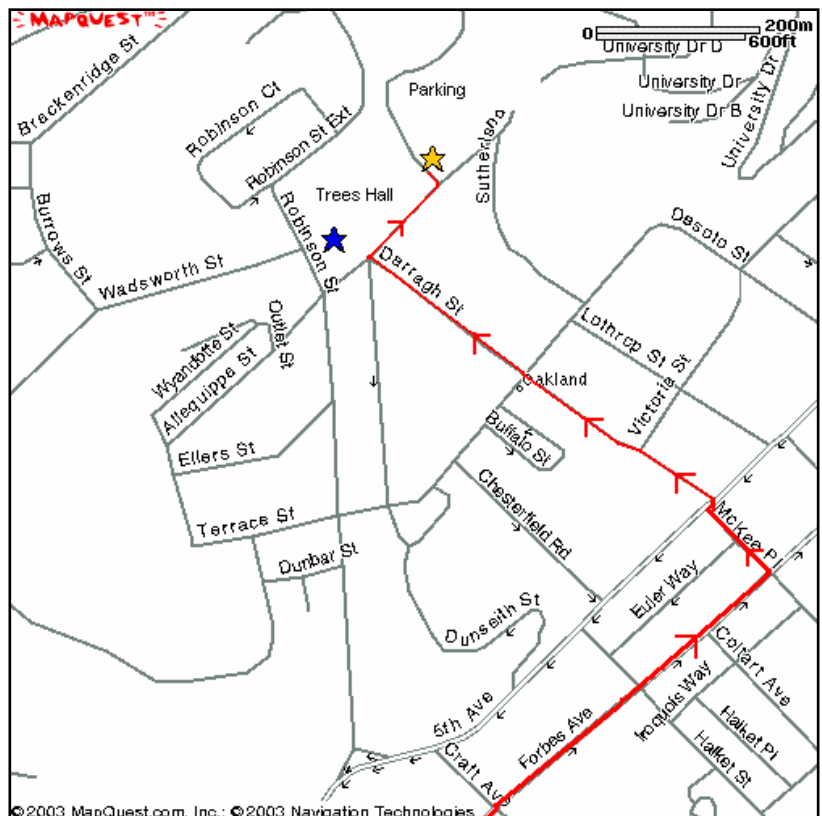

* Gold/grey star is parking. Blue/black star is Trees Hall. Multipurpose Room accessible via Allequippa St entrance.